

NIT  2016

ES GRANER

485 BALAS DE PAJA

Resumen del Presupuesto:

485 Balas de Paja Compactadas (Inifugas)
 485 Estacas de Madera
 11.25 m2 de Trames
 Iluminación Indirecta (Focos, Led...)
 Refuerzos Estructurales (Gaviones, Dinteles de Madera, Guías...)
 Traslado de Material y Montaje (3 Operarios, 2 Jornadas y Grúa)

2 eur/ud. 970 eur
 0,8 eur/ud. 388 eur
 7,13 eur/m2 80.20 eur
 550 eur
 424 eur
 1168.40 eur

TOTAL

3580.60 euros

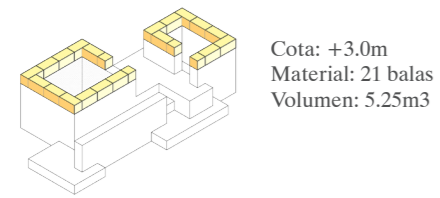

Cota: +3.0m
 Material: 21 balas
 Volumen: 5.25m3

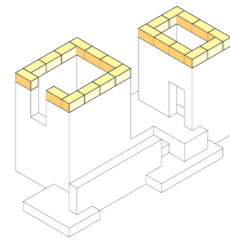

Cota: +5.5m
 Material: 22 balas
 Volumen: 5.5m3

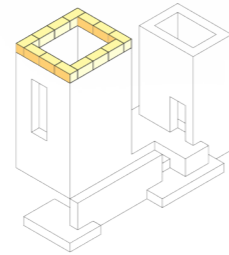

Cota: +8.0m
 Material: 13 balas
 Volumen: 3.25m3

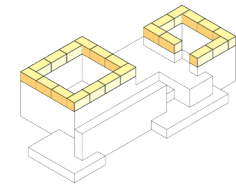

Cota: +2.5m
 Material: 22 balas
 Volumen: 5.5m3

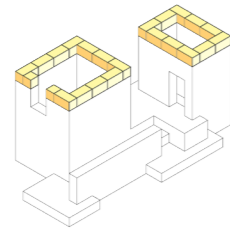

Cota: +5.0m
 Material: 22 balas
 Volumen: 5.5m3

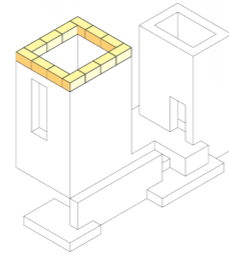

Cota: +7.5m
 Material: 13 balas
 Volumen: 3.25m3

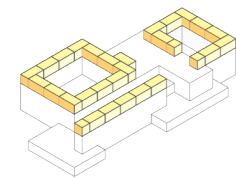

Cota: +2.0m
 Material: 29 balas
 Volumen: 7.25m3

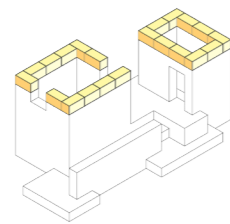

Cota: +4.5m
 Material: 21 balas
 Volumen: 5.25m3

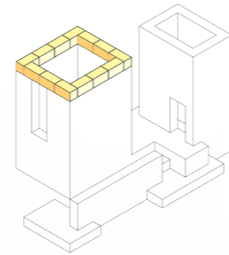

Cota: +7.0m
 Material: 13 balas
 Volumen: 3.25m3

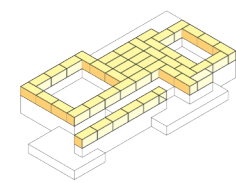

Cota: +1.5m
 Material: 47 balas
 Volumen: 11.75m3

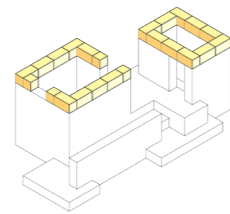

Cota: +4.0m
 Material: 21 balas
 Volumen: 5.25m3

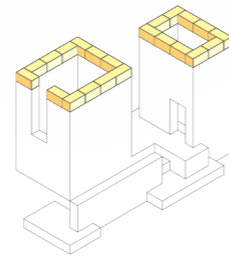

Cota: +6.5m
 Material: 22 balas
 Volumen: 5.5m3

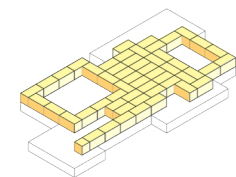

Cota: +1.0m
 Material: 55 balas
 Volumen: 13.75m3

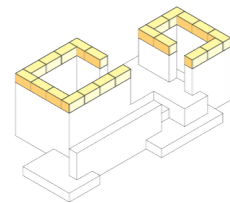

Cota: +3.5m
 Material: 21 balas
 Volumen: 5.25m3

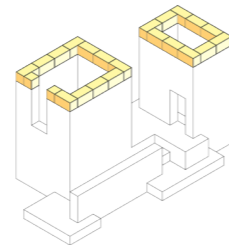

Cota: +6.0m
 Material: 22 balas
 Volumen: 5.5m3

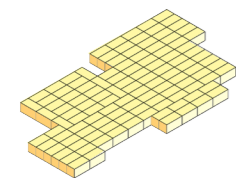

Cota: +0.5m
 Material: 121 balas
 Volumen: 30.25m3

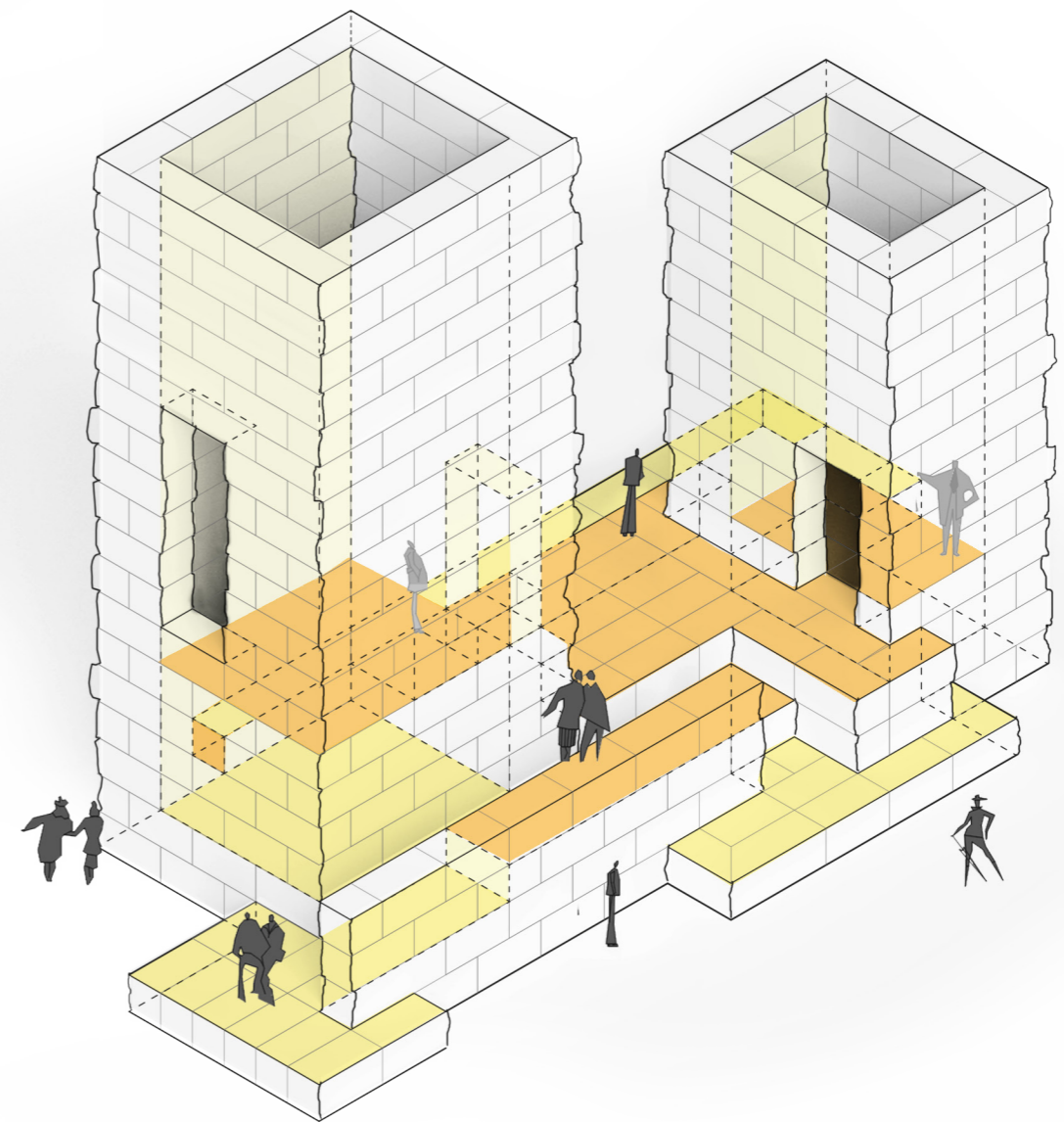

Axonometría espacial dual interior-exterior